

LOWFLOW Quick-Start Guide



Designed for flow rates between 2-8L/min

This Quick-Start Guide has been created to introduce Getting Started with the LOWFLOW and crucial information on safe operation of the machine

What's in the box?

- Airbox unit
- Air sampling head
- Power cable
- Charger
- USB with full user manual

Keypad Overview

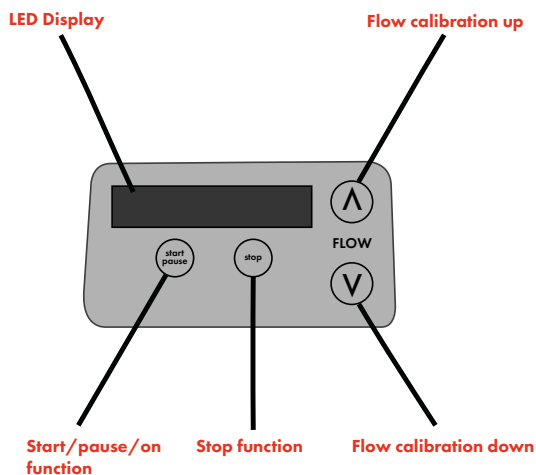

1. Getting Started

1.1 Before you use the LOWFLOW pump make sure it is fully charged. You will need to attach the red terminal to the battery. A battery level indicator shows the available power when the unit is first switched on.

1.2 The LOWFLOW can be run directly from the mains but only when used with the optional 4A charger (Product Code: PT30592LF) NOTE: Battery must be attached.

IMPORTANT: BEFORE RUNNING TEST YOU WILL NEED TO SET THE FLOW RATE
Ensure that the mechanical flow rate adjuster is OPEN (see Fig. 1).
Turn anticlockwise to OPEN and clockwise to CLOSE.

Fig. 1

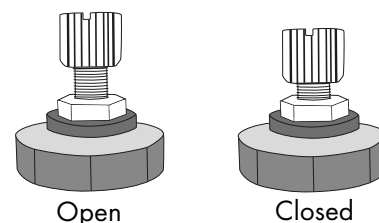

2. Setting the flowrate

2.1 - Setting the flowrate between 5-8L/min

CAUTION: REDUCE FLOW RATE BY DIGITAL DISPLAY TO 5L/MIN BEFORE USING THE NEEDLE VALVE ADJUSTMENT (Fig.8)

The pump is set at approx 8 L/min as a default, to fine tune this:-

2.1.1 Before switching on the LOWFLOW connect a flow meter to the air sampling head.

2.1.2 Press start/pause to switch on the unit. (Fig.2) The display will show, in this order: The serial number, the current firmware version and the battery status.

2.1.3 Press start/pause the display shows 'Flow not set'. (Fig.3)

2.1.4 Press either arrow to begin Calibration Mode, the pump will start running. (Fig.4)

NOTE: Run for 45 seconds to allow to stabilise. (Fig.5)

2.1.5 Press up/down arrows to adjust flow rate. (Fig.6)
(A single press advances the display by one increment, holding while pressing advances the display by 10 increments).

2.1.6 Check the flow rate against the flow meter and adjust according to flow requirements.
(Any increment changes will be saved for the post test flow check).

2.1.7 Once flow is adjusted to required flow rate, set the flow rate by pressing stop. (Fig.7)

Display shows Flow Set

2.2 - Setting the flowrate between 2-5 L/min

2.2.1 Follow the switch on procedure as above

2.2.2 Press up/down arrows to adjust flow rate down to 5 l/min (see above)

2.2.3 Once 5 l/min has been reached, slowly turn the mechanical flow rate adjuster clockwise to close needle-valve and reduce flow. (Fig.8)

CAUTION: When restarting pump at new job and before calibrating flow rate, always ensure the mechanical flow rate adjuster is open. Then follow steps to calibrate flow rate

IMPORTANT: If the pump is shut down between setting the the flow and starting the test, flow will have to be reset by repeating the steps above.

3. Charging the battery

When the charger is plugged into the charging socket a red LED will be illuminated. The LED will change to green when the battery is fully charged. It takes approximately 6-8 hours to completely charge the battery.

4. Replacing the battery

The LOWFLOW pump has been specifically designed to make replacing the battery a quick and easy task. Simply undo the two screws on the front of the battery housing, pull off the terminal connectors, remove the battery and replace.

NOTE: This process is made easier if pump is lying on it's back.

IMPORTANT: The terminals on the battery are colour coded red and black to match the red and black wires of the unit. When fitting a new battery make sure that these match up correctly.

5. Replacing the mast

The mast is secured on the unit in a threaded housing, so to replace just unscrew and remove.

IMPORTANT: Please do not lift the pump by the mast

6. Cleaning the LOWFLOW

The casing of the LOWFLOW pump is made from a hard wearing ABS structural foam, making it incredibly rugged and also very easy to clean. Tested to IP65 standards ('Protected against low pressure water jets from any direction.') The unit can be cleaned under a shower hose

Fig. 2

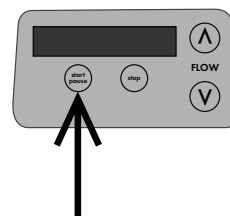

Fig. 3

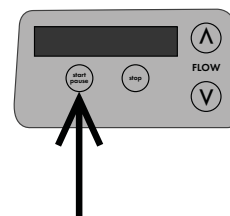

Fig. 4

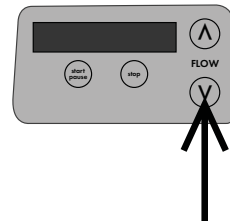

Fig. 5

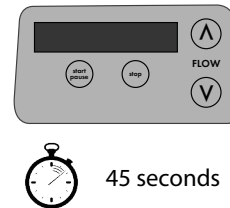

Fig. 6

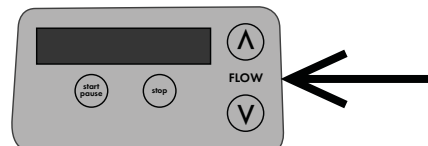

Fig. 7

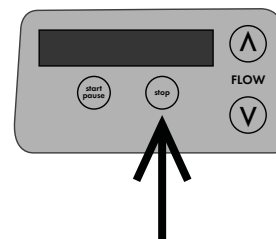
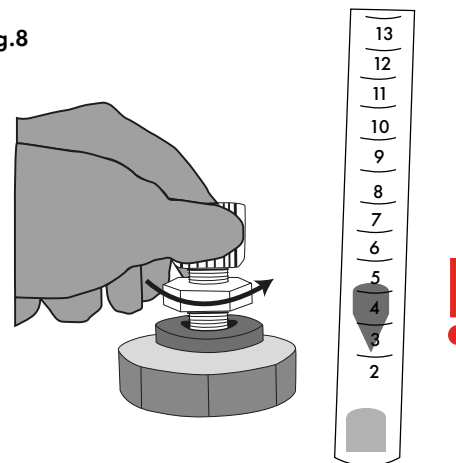

Fig.8



Scan QR code or [click here](#) to download full user manual and see further troubleshooting

T: +44 (0)1903 524 600
E: sales@airboxsp.com